

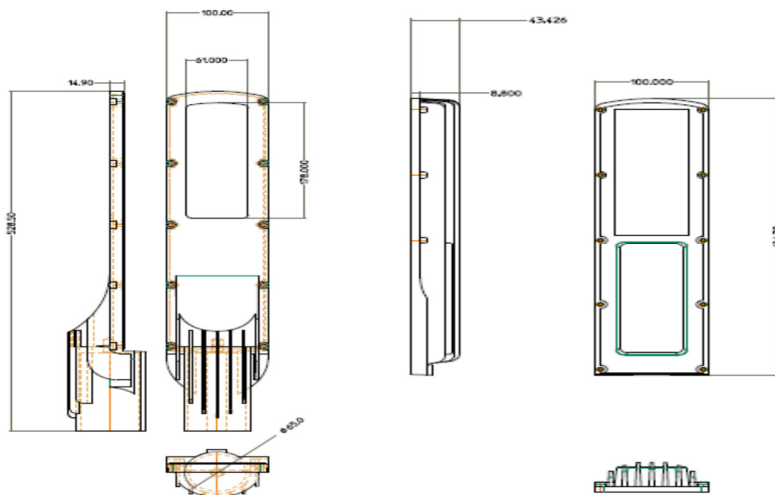

SOLAR LED STREET LIGHT LUMINAIRE

BSZSL AR 24W LED – 01 (WITH LENS)



NOMINAL DIMENSIONS IN mm Tolerance +/-5

Application

- Residential complexes,
- Small Roads,
- Rural Road,
- Parks & Garden,
- Security lighting, etc.

Specification

- Epoxy powder coated Die-cast Aluminium housing with weatherproof gasket.
- Die-cast aluminium frame with heat resistance toughened clear glass with SS screws.
- The streetlight is provided with 16 Nos. of high efficacy LEDs with colour temp 6000 ±1000 Deg K.
- Suitable to work on 12 Volts Battery back-up.
- The Composite charge controller is provided with auto switch built-in for Dusk to Dawn operation.
- The luminaire is also provided with LED indicator for understanding status of battery.
- Weight of luminaire is 2kg.
- Protection is provided against lighting and short-circuits.
- Degree of protection: IP65

Electrical Data

Product Code	Cat Ref.	Volts (V DC)	Nominal System Current (DC Amp.)	Nominal System Wattage (DC W)
-----	BSZSL AR 24W LED - 01	12	2.00	24

Data subject to variation due to change/improvement in the design, materials and processes.

	DRAWN	NSS	01/11/2013	FOR –
	CHECKED	NSS	01/11/2013	REV - 00 DATE-01/11/2013
	APPROVED	KN		DRG. No
	DATA SHEET RELEASED ON DT-			BSZSL AR 24W LED - 01